

HCRH4D28 TYPE

TYPE

HCRH 4D28

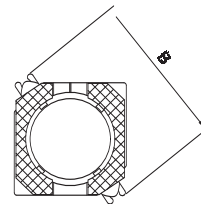
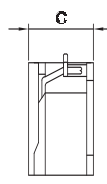
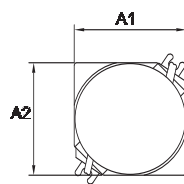
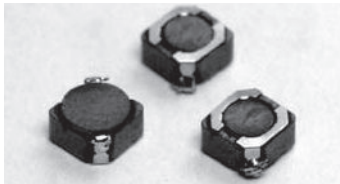

A1: 5.0 MAX.
A2:5.0 MAX.
B: 6.9 MAX.
C: 3.1 MAX.

DIMENSION

SPECIFICATION

ITEM	L	DCR	IDC
HCRH4D28	(μ H)	MAX.(m Ω)	MAX.(A)
1R2N	1.2 \pm 30%	42	2.56
1R8N	1.8 \pm 30%	44	2.20
2R2N	2.2 \pm 30%	47	2.04
2R7N	2.7 \pm 30%	49	1.60
3R3N	3.3 \pm 30%	57	1.57
3R9N	3.9 \pm 30%	74	1.44
4R7N	4.7 \pm 30%	80	1.32
5R6N	5.6 \pm 30%	90	1.17
6R8N	6.8 \pm 30%	98	1.12
8R2N	8.2 \pm 30%	124	1.04
100N	10 \pm 30%	134	1.00
120N	12 \pm 30%	144	0.84
150N	15 \pm 30%	165	0.76
180N	18 \pm 30%	190	0.72
220N	22 \pm 30%	248	0.70
270N	27 \pm 30%	261	0.58
330N	33 \pm 30%	320	0.56
390N	39 \pm 30%	360	0.50
470N	47 \pm 30%	480	0.48
560N	56 \pm 30%	500	0.41
680N	68 \pm 30%	550	0.35
820N	82 \pm 30%	660	0.32
101N	100 \pm 30%	760	0.29
121N	120 \pm 30%	1027	0.27
151N	150 \pm 30%	1450	0.24
181N	180 \pm 30%	1550	0.22

N: \pm 30%

* Hong can design any part to your requirements with different inductance.

* All parameters as this content presented are subject to final specifications both sides confirmed.